

ADDING A PATIO DOOR TO AN Xi WALL

Carefully follow the instructions and cautions listed below when adding a patio door to an Xi Superior Walls® foundation.

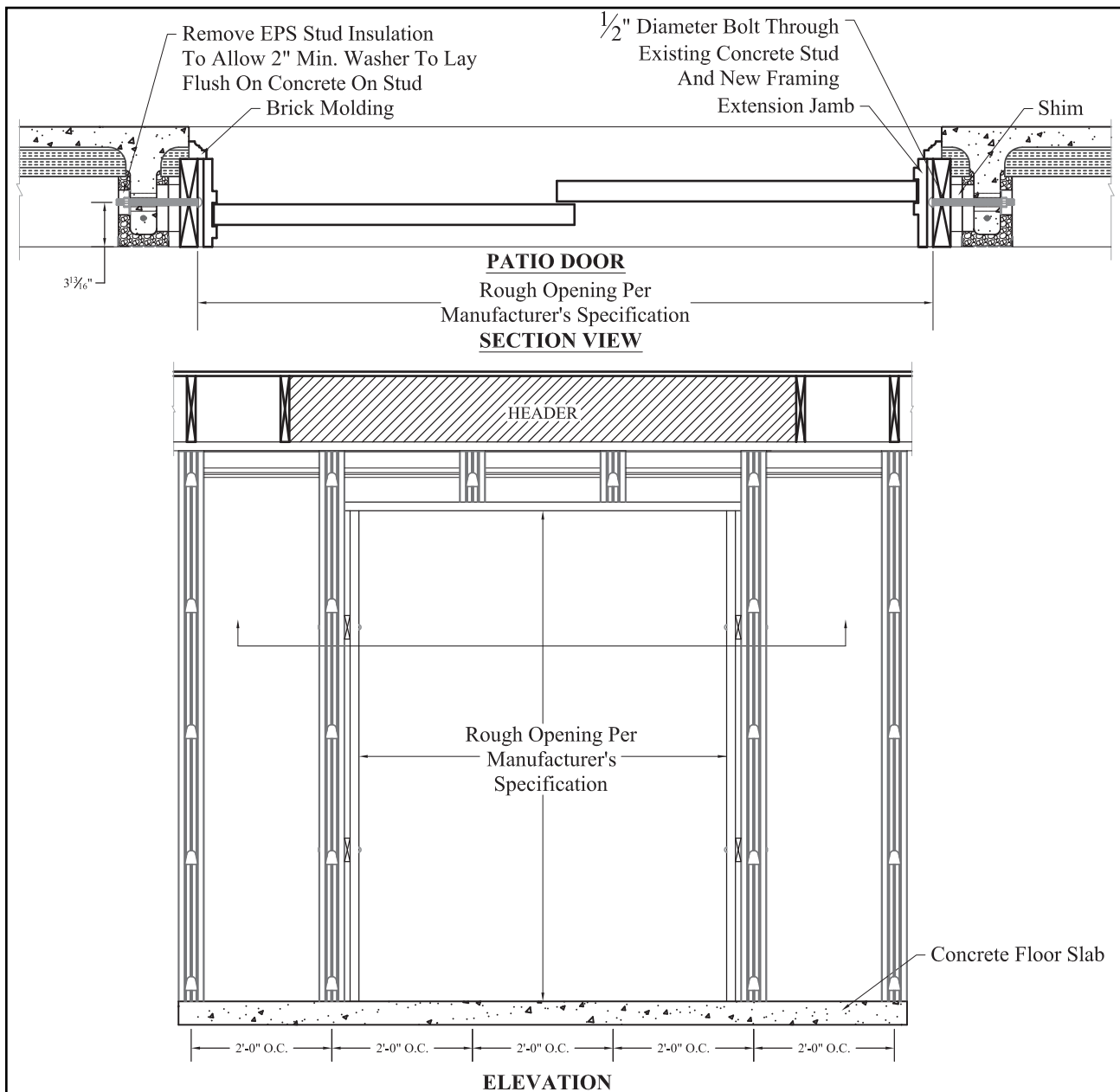

CUTTING A PATIO DOOR OPENING INTO AN Xi WALL

If a patio door opening is missing or added to the plans after production, it can be field cut (It is advisable that the door used has a Max. width of 5'-0"). Locate the opening so that only two studs will be cut, and where the band board and sill plate run continuously over the opening. A properly sized header must be placed above the opening.** Cut wooden framing square on the top end and at a 4 deg angle on the bottom to fit tightly against top and bottom beam and bolt to existing concrete studs through the precast chase holes. 1" X 2" boards can be used to shim between the jamb and the concrete studs. Remove the stud insulation wherever shims are located so that the shims rest directly against the concrete stud. Install the new door according to the manufacturer's specifications.

- **Never cut in a door or window opening under a beam pocket or point loaded area.
- **Each job should be individually reviewed by a person competent in applying the structural design principals involved. In many jurisdictions this will require a registered design professional.